

AisleLok[®] Adjustable Mounting Post Assembly Instructions

Covers Part Number:
10167-45B

Carton contains:

- (1) Bottom Post Assembly
- (1) Top Post Assembly
- (1) Floor Mounting Kit
 - a. (4) 3/8"-16 x 4" Carriage Bolts
 - b. (4) 3/8" Flat Washers
 - c. (4) 3/8"-16 Lock Nuts
 - d. (2) 1 5/8" W x 13/16" H x 30" L Framing Channels
- (1) Hinge Back Plate Replacement Kit
 - a. Short Hinge Back Plate
 - b. #10 Torx Bit

Floor Mounting Kit

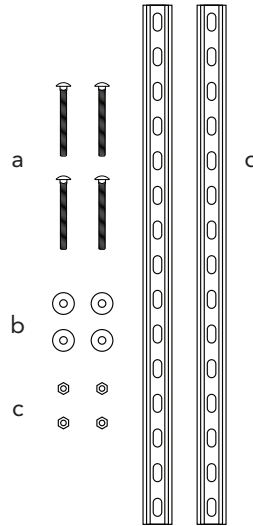

Hinge Back Plate Replacement Kit

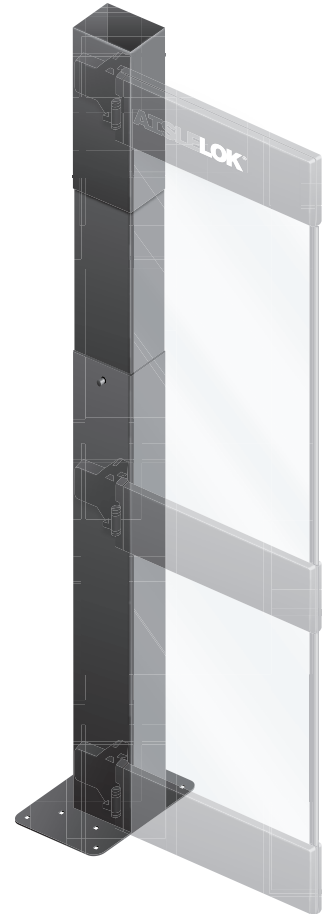
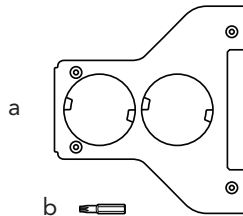

Tools Required:

- (1) Pencil or other marking device
- (1) Hand held drill, or drill press can be used if it can accommodate a full raised floor tile
- (1) 1/2" Drill bit
- (1) 9/16" Wrench or ratchet with socket
- (1) Tape measure

Handle Mounting Post with Care:

The AisleLok[®] Adjustable Mounting Post is designed for indoor use only. The post assemblies are constructed from 16 gauge sheet steel and the base plate (which mounts to the raised floor surface) is constructed from 11 gauge sheet steel. The post assemblies have a smooth black powder coated finish, therefore when cleaning the product it's recommended to use a damp cloth.



SAFETY REQUIREMENTS

Use caution when unpacking The AisleLok[®] Adjustable Mounting Post, the robust design of this product makes some of the parts heavy.

The AisleLok[®] Adjustable Mounting Post is designed to attach to the raised floor surface using the supplied hardware. Modifications to the raised floor tile are required to attach the bottom base section. Use caution when determining placement of the bottom base and when drilling the necessary holes in the raised floor.

For Sales and Installation, contact:



(800) 328-2256 • www.dataclean.com

Preparation

The AisleLok[®] Adjustable Mounting Post is designed to be installed at the end of an uneven row of cabinets or in a location where the AisleLok[®] Bi-Directional Doors or AisleLok[®] Adjustable Rack Gap Panel cannot be installed due to the lack of available sheet metal surface space or obstructions. The AisleLok[®] Adjustable Mounting Post consists of a bottom post assembly, top post assembly and a floor mounting kit. First, determine where the base plate will attach to the raised floor. Before drilling mounting holes in the raised floor tile(s), make sure the placement of the metal framing channel under the floor does not conflict with the stringer placement or any other underfloor obstructions. The side of the bottom plate that does not protrude past the vertical face of the post can be aligned with a tile edge (or up against another surface, i.e. a wall) so the adjacent tile is not captured by the base plate. When using with the AisleLok[®] Bi-Directional Doors the wide side of the post must be parallel with the plane of the AisleLok[®] Bi-Directional Doors. An AisleLok[®] Adjustable Rack Gap Panel can also be mounted to either the wide or narrow side of the post. Second, use a pencil or marker to mark the inner or outer set of mounting holes in the base plate. The two sets of holes are provided to avoid interference with stringers. Use the holes which best accommodate your situation.

Installing the AisleLok[®] Adjustable Mounting Post

1. Use a 1/2" drill bit to drill the marked holes (4) in the raised floor tile (the holes will be used for the 3/8"-16 x 4" L carriage bolts).
2. After drilling the holes (4), place the bottom post assembly over the drilled set of holes. Place the provided 3/8"-16 X 4"L carriage bolts (4) through the base plate and raised floor tile.
3. Underneath the raised floor tile use the provided 1-5/8" W X 13/16" H X 30" L (2) metal framing channel, 3/8" flat washers (4) and 3/8" lock nuts (4) to securely attach the base plate to the raised floor. The lengths of metal framing channel should be placed so they capture two separate sections of raised floor stringers, this creates the greatest stability of the post. Once the bottom assembly has been securely attached to the raised floor tile you can then proceed with installing the top post assembly.
4. Pull and twist the spring loaded retention pin to lock the pin in the out position. Place the top assembly section inside the bottom assembly. Once the top assembly has been inserted past the retention pin, then release the retention pin. Slowly and carefully slide the top post assembly further into the bottom post assembly until the retention pin slides into one of the height adjustment holes in the top post assembly.
5. The Adjustable Mounting post has two height positions appropriate for approximately 42U and 45U height racks.

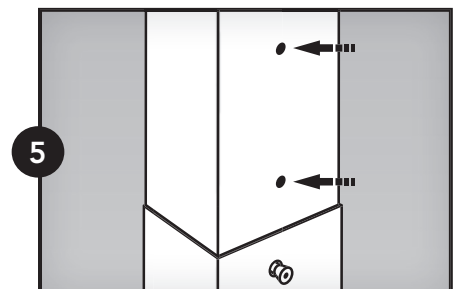
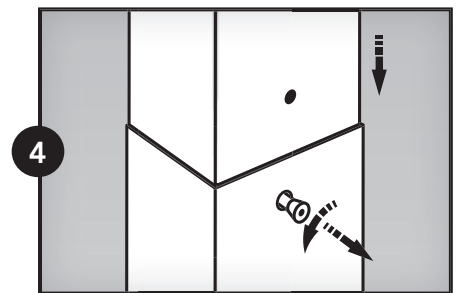
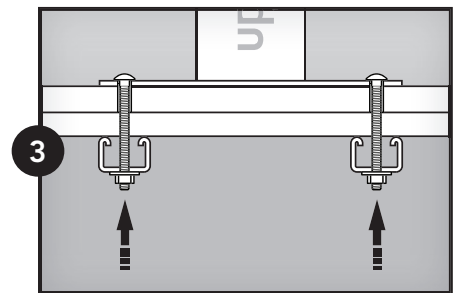
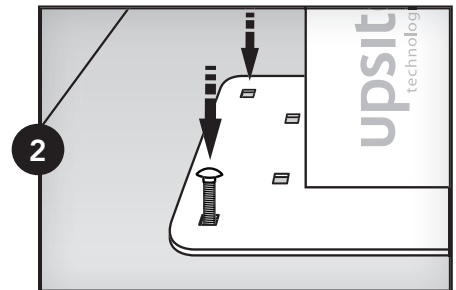
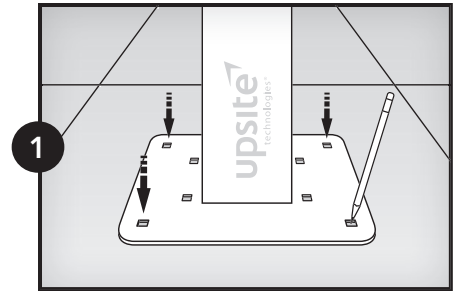

For Sales and Installation, contact:

Installing the Replacement Hinge Back Plate

The top hinge on the AisleLok® Bi-Directional Doors by design includes a Long Hinge Back Plate which attaches to the hanger bracket mounted to the top of a cabinet. When installing the AisleLok® Bi-Directional Doors to the AisleLok® Adjustable Mounting Post, this bracket will extend past the Adjustable Mounting Post.

To prevent this from being an obstruction, the standard Long Hinge Back plate needs to be replaced with the supplied Short Hinge Back plate. To replace the Hinge Back Plate on the AisleLok® Bi-Directional Doors:

1. Use the included #10 Torx bit to remove the (4) screws securing the Long Hinge Back Plate of the top hinge. Remove the Long Hinge Back Plate.
2. Replace the Long Hinge Back Plate with the new Short Hinge Back Plate.
3. Secure the new Short Hinge Back Plate with the original screws.

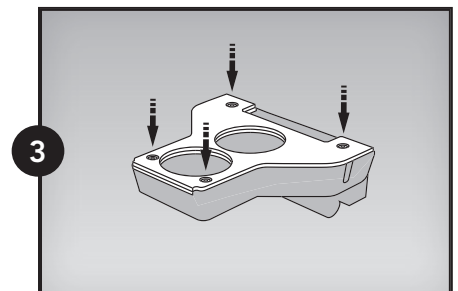
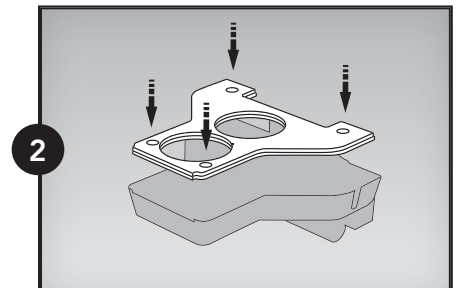
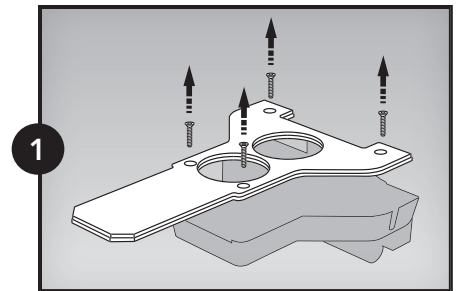

For Sales and Installation, contact:



(800) 328-2256 • www.dataclean.com

Installation Guide

Limited Warranty

Upsite Technologies, Inc. (the Company) warrants to the original purchaser that products delivered hereunder will be free of defects in materials and workmanship for a period of twelve (12) months from the date of purchase (the "Warranty Period").

The Company shall, at its option, within the Warranty Period, either repair or replace free of charge, any product or part thereof found, upon the Company's inspection, to be defective in materials and workmanship, and will return the repaired or replaced product to the purchaser at Company's expense.

For warranty service and shipping instructions, contact the Company at the telephone number shown below. If the product is under warranty and the defect appears to be covered by this Limited Warranty, the Company will issue to the purchaser a Notice of Authorization For Warranty Return. Products returned to the Company for warranty service must be accompanied by a statement of defect, the Notice of Authorization for Warranty Return provided by the Company , and proof of purchase.

This Limited Warranty is conditioned on the following:

1. The Company must be notified within 12 months of purchase and have been given the opportunity of inspection by return of any alleged defective product free and clear of all liens and encumbrances to the Company or its manufacturer; and
2. The product must not have been abused, misused, or improperly maintained, and/or non-Upsite authorized repair performed during such period; and
3. Such defect has not been caused by corrosion or exposure to other than ordinary wear and tear; and
4. The installation and use of the product has been in accordance with the manufacturer's instructions and not been modified or customized to include but not limited to cut, resized, burned, glued, bent, re-shaped, disassembled, attachments added to, improperly installed or used in a manner other than intended.

The company makes no other express or implied warranty or representation of any kind whatsoever including any warranty of merchantability or fitness for a particular purpose and all such other warranties are hereby included.

The Company's maximum liability hereunder is limited to the purchase price of the product. In no event shall the Company be liable for any consequential, indirect, incidental, or special damages of any nature arising from the sale or use of the product, whether based in contract, tort, strict liability, or otherwise.

Note: Some jurisdictions do not allow limitations on incidental or consequential damages or how long an implied warranty lasts, so that the above limitations may not fully apply. This warranty gives specific legal rights and you may also have other rights which may vary from jurisdiction to jurisdiction.

For complete warranty and repair information Call (888) 982-7800 or visit upsite.com

U.S. and International Patents Pending



Designer and Manufacturer
888.982.7800
www.upsite.com

For Sales and Installation, contact:



(800) 328-2256 • www.dataclean.com

84072A ©2016